

ALPINE MEADOWS WATER AND SEWER DISTRICT ALPINE MEADOWS DISTRIBUTION IMPROVEMENTS PROJECT

Currently Scheduled Shutdowns: 5/19/16, 8:00 am—4:00 pm

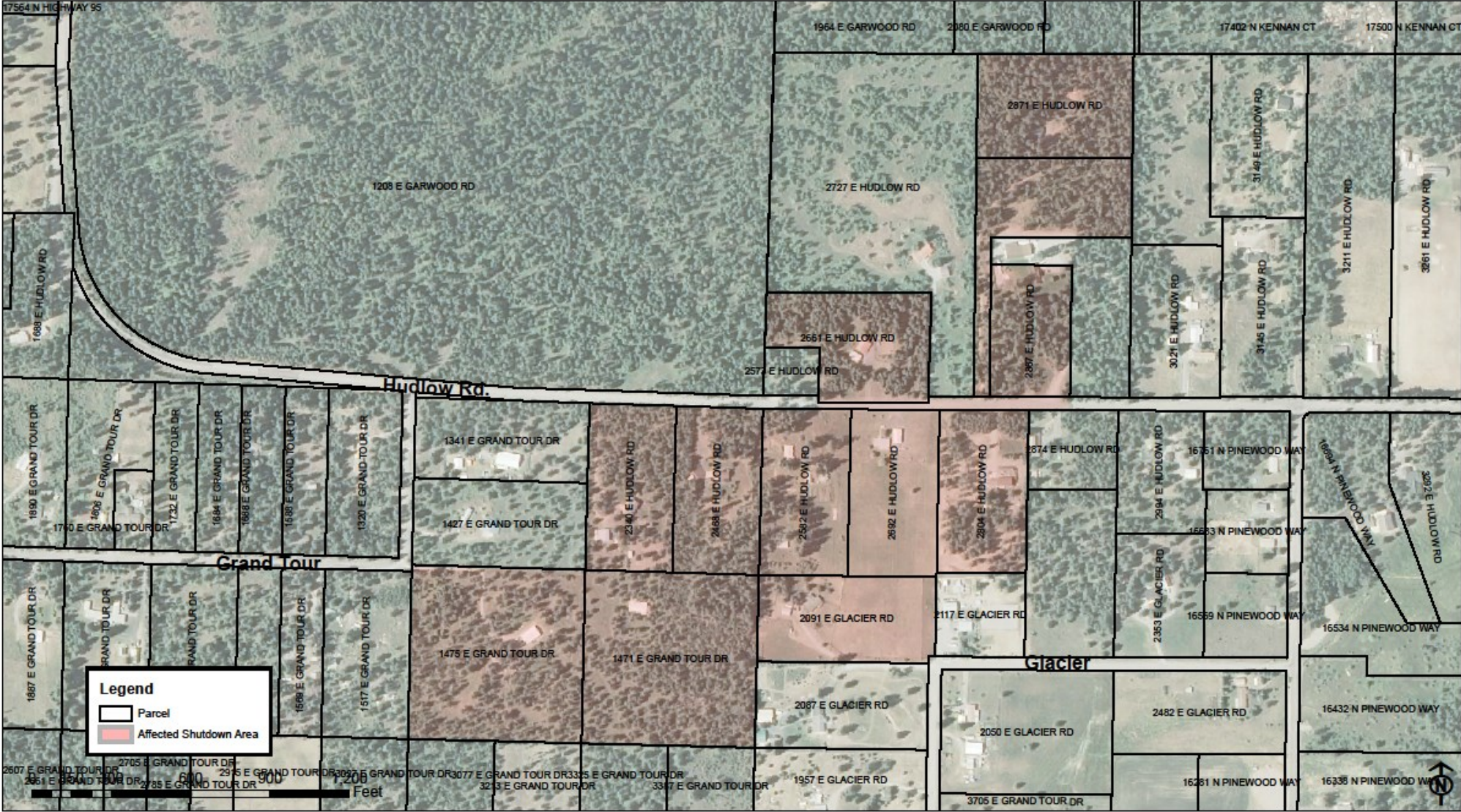

WELCH-COMER
ENGINEERS | SURVEYORS
www.welchcomer.com 208-664-9382
COPYRIGHT 2015
Welch-Comer & Associates, Inc.
This document, and ideas and designs incorporated herein, are an instrument of professional service, in the property of Welch-Comer & Associates, Inc., and is not to be used in whole or in part for any other project without the written authorization of Welch-Comer & Associates, Inc.

Alpine Meadows Water & Sewer District
Cross Country Section
Affected Shutdown Area

Sources:
Kootenai County GIS
PROJECT NO.41132
DRAWN BY.....CW
FILENAME.....AffectedArea
DATE.....04/13/2016

Project Engineer: Welch Comer
Contractor: Earthworks Northwest, Inc.

